

PE  
LG  
R42

FOUNTAIN DISTRICT SURVEY AREA FOR  
THE PUEBLO HISTORY SURVEY OF  
POTENTIALLY ELIGIBLE  
DISTRICTS

*This was originally recorded under site number  
5PE.509 as a district. As no official  
determination was made, and in accordance with  
the district/survey area resolution, it was made  
into this document. ESchmelzer 10/2010*

J. Munch  
Pueblo Regional Planning Commission  
August 1981

Sites originally recorded in the Potential Fountain District Historic District 5PE.509.  
29 sites

5PE.1177  
5PE.7503  
5PE.7504  
5PE.7127  
5PE.7505  
5PE.7128  
5PE.7129  
5PE.7130  
5PE.7133  
5PE.7506  
5PE.7135  
5PE.7507  
5PE.7508  
5PE.7134  
5PE.7509  
5PE.7510  
5PE.7511  
5PE.7512  
5PE.7513  
5PE.7514  
5PE.7515  
5PE.7516  
5PE.7517  
5PE.7518  
5PE.7519  
5PE.7142  
5PE.4376  
5PE.7521  
5PE.7522

INVENTORY RECORD



IMPORTANT: COMPLETE THIS SHEET FOR EACH RESOURCE PLUS EITHER AN ARCHAEOLOGICAL OR HISTORICAL/ARCHITECTURAL COMPONENT FORM.

NOT FOR FIELD USE
DET. ELIG.
DET. NOT ELIG.
NOMINATED
LISTED, DATE

#62

I. IDENTIFICATION: 1) Resource No. SPE-509 2) Temp. No. NA

3) Resource Name Fountain District 4) Project Name Pueblo Historic Survey

5) Category: Arch. Site   , Hist./Archit. Structure   , Hist./Archit. District X

6) (For Arch. site) In a District: yes    no   ; Name   

*SEE ENCODING SHEET*

II. LOCATION: 7) Township 20S; Range 64W;    of    of    of    of

Section 30&31; P.M. 6th 8) County Pueblo

9) USGS QUAD NE Pueblo; 7.5<sup>X</sup> 15; Date 1961 Attach photocopy

portion of Quad. Clearly show site. 10) Other maps   

11) Dimensions    mX    m 12) Area    sq.m(+4047=) 56 acres

13) UTM Reference: (One UTM centered on resource may be given for resource under 10 acres.)

A. 1 3; 5 3, 5 0, 5, 0 mE; 4, 2 3, 6 4, 9, 0 mN. B. 1 3; 5 3, 5 5, 8 0 mE; 4, 2 3, 6 2, 2, 0 mN. See quad

C. 1 3; 5 3, 5 0, 7, 0 mE; 4, 2 3, 5 8, 1, 0 mN. D. 1 3; 5 3, 5 6, 0 0 mE; 4, 2 3, 5 8, 2 0 mN. for addition

E. 1 3; 5 3, 5 1, 8 0 mE; 4, 2 3, 6 4, 9 0 mN. F. 1 3; 5 3, 5 3, 5 1 mE; 4, 2 3, 6 2, 0 0 mN. UTMs

14) Address NA Lot    Block    Addition   

III. MANAGEMENT DATA: 15) Field Assessment: Eligible    Not Eligible    Need Data X

16) Owner/Address NA

17) Gov't. Involvement: County    State    Federal    Private   ; Agency None

18) Disturbance: none    light    moderate    heavy    total   ; Explain Exhibits changes which

have occurred over time:   

19) Threats to Resource: Water Erosion    Wind Erosion    Animal Activity    Neglect X Vandalism   

Recreation    Construction   ; Comments None

20) Management Recommendations None--pending completion of the Pueblo Cultural Resources

Management Plan.   

V. REFERENCE: 21) State/Fed. Permit Nos.   

22) Photo Nos.   , on file at SHPO, Colo. Hist. Soc.

23) Report Title Pueblo Historic and Architectural Survey

24) Recorder J. Munch 25) Recording Date 8/81

26) Recorder Affiliation Pueblo Regional Planning Commission 27) Phone No. 543-6006

V. SKETCH MAP: Map all features and show the boundaries of the resources. Show all major topographic features, permanent modern features, and vegetation zones as appropriate. Give names of features, streets and addresses if known. Provide scale, key and direction.  
Please see accompanying map

scale:

key:



true

mag.

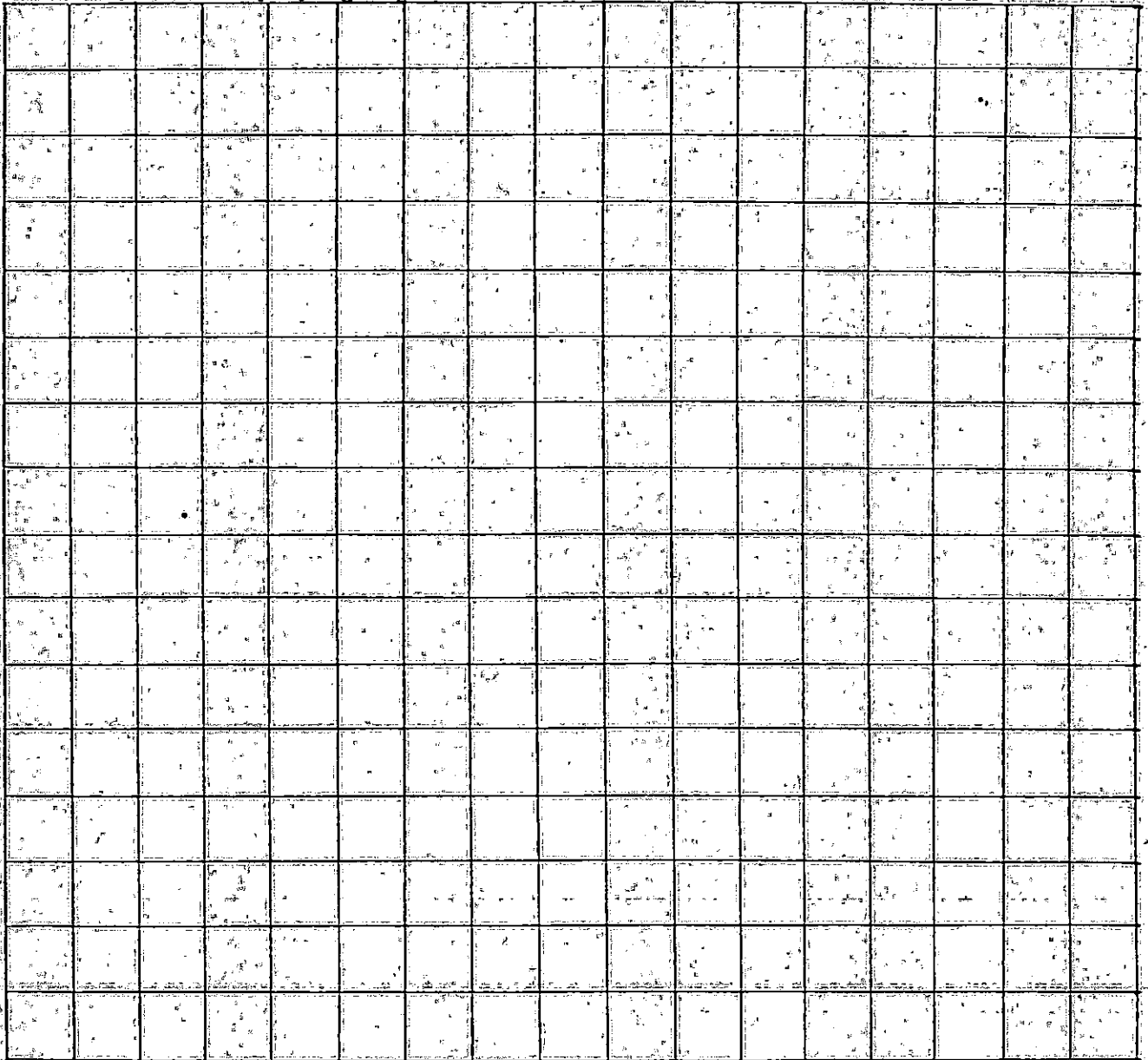

28) Location/Access: See attached map.

29) Boundary Description: Beginning at Point 1 on Erie even with the alley between East 4th and East 5th, thence east to Iola, thence north to the alley between East 8th and East 9th, thence west to Fountain Avenue, thence north to the alley between East 11th and East 12th, thence west to Erie, thence south to Point 1.

30) Boundary Justification:



ARCHITECTURAL/HISTORICAL COMPONENT FORM

**IMPORTANT:** USE IN CONJUNCTION WITH THE GREEN INVENTORY RECORD FORM FOR RECORDING HISTORIC STRUCTURES AND DISTRICTS. USE SEPARATELY FOR RECORDING STRUCTURES LOCATED WITHIN DISTRICT BOUNDARIES.

1) Resource No. 5PE-509 2) Temp No. NA 3) Name Fountain District  
Inventory

4) Address See Boundary Description/Record 5) District Name Fountain District

I. INTEGRITY: 6) Condition: Good  Fair  Deteriorated

7) Original Use Residential 8) Present Use Residential

9) Original Site  Moved  Date(s) of Move: \_\_\_\_\_

10) Unaltered  Altered  Explain: District exhibits changes which have occurred over time.

II. DESCRIPTION: 11) Building Materials Brick/wood/stone

12) Construction Date 1890-1930 13) Architect/Builder NA

14) Architectural Style(s) Venacular/Victorian to Bungalow

15) Special Features/Surroundings: See attached Description

16) Archaeological Potential: Yes  No  Unknown  Explain: \_\_\_\_\_

III. CULTURAL ACTIVITIES: Key the resource type (ie: house, barn, shed, school, church, etc) to the cultural activity theme and sub-theme category associated with it.

17) THEME Earliest East Pueblo Development

18) SUB-THEME Land speculation--middle class businessmen

19) TYPES

(Attach Photographs)

Frame Number

Roll Number

Facade Orientation

IV. SIGNIFICANCE: Assess whether or not the resource has any historical or architectural merit by checking appropriate categories and justifying below. Include any relevant historical data.

20) Architectural Significance:

- Represents work of a master
- Possesses high artistic values
- Represents a type, period, or method of construction

21) Historical Significance:

- Associated with significant persons
- Associated with significant events or patterns
- Contributes to the significance of an historic district

22) List Any Associated Cultural Group: \_\_\_\_\_

V. REFERENCES:

FOUNTAIN--RESIDENTIAL DISTRICT

The Fountain District is roughly bounded by Fountain Street on the west, the alleys between 11th and 12th Streets and 9th and 10th Streets on the north, Joplin Street on the east, and the alley between 4th and 5th Streets on the south. This district is a portion of the East Pueblo Subdivision. The plat for this subdivision was recorded in 1872. The Fountain Creek District, as with the other east Pueblo districts, exhibits a wide period of development. Within this district both Victorian and Bungalow style structures can be found. This district is differentiated from the other districts in that it contains a higher concentration of 1890-1900 vintage structures than the others. These are predominantly brick structures. Many of these structures appear to be tract houses. Many of these structures are similar to those found in the Lower East Side District and the Bessemer District. Portions of this area were first mapped by the Sanborn Insurance Company in 1893 and 1904.

JFM:lr  
8/81

E. 13535180 ME 4236490 MI  
F. 13535180 ME 4236200 MI

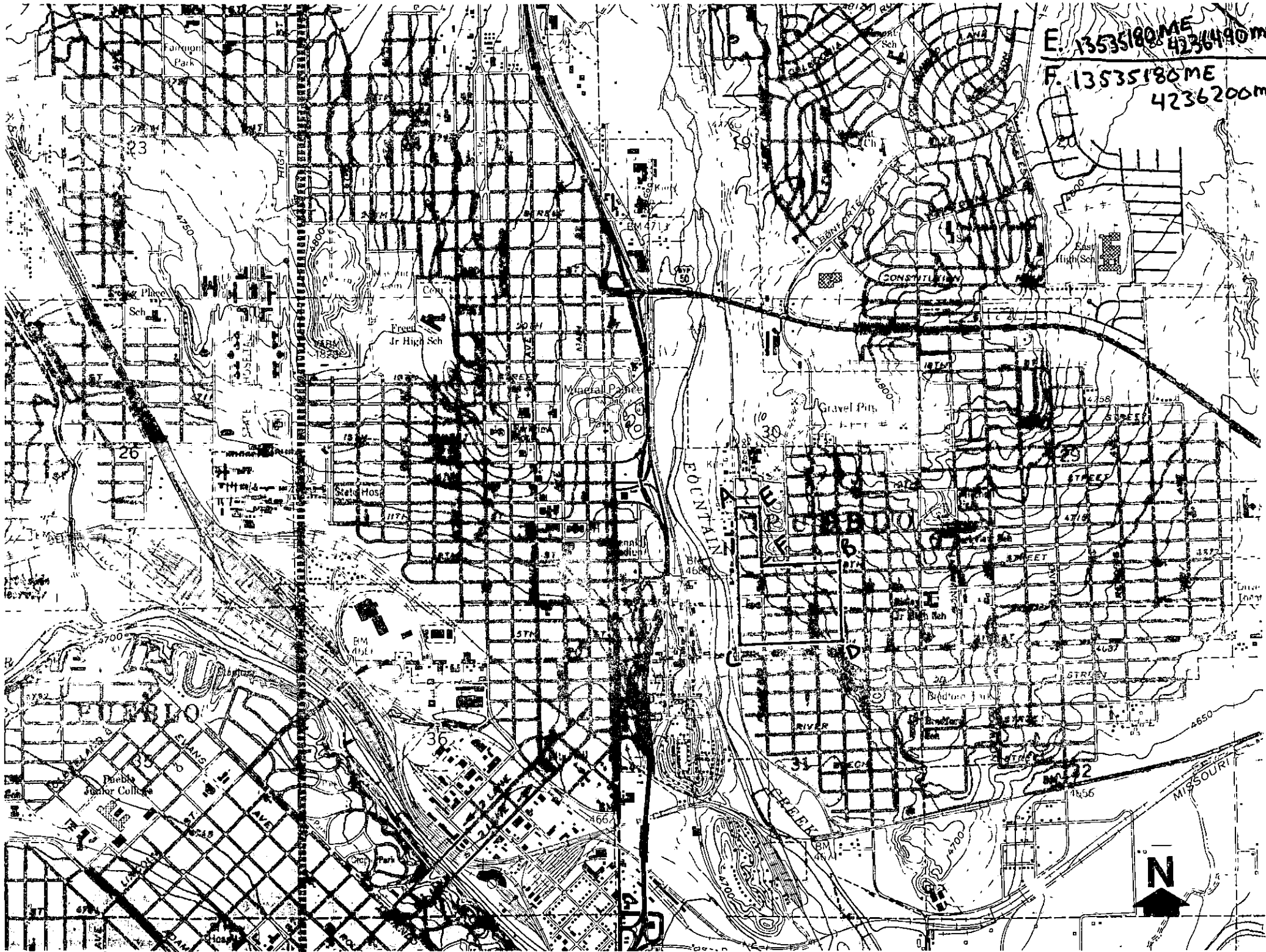

PUEBLO QUADRANGLE    NORTHEAST PUEBLO QUADRANGLE

SITE NO    CDF-509